

Labyrinth plastic seal Type S

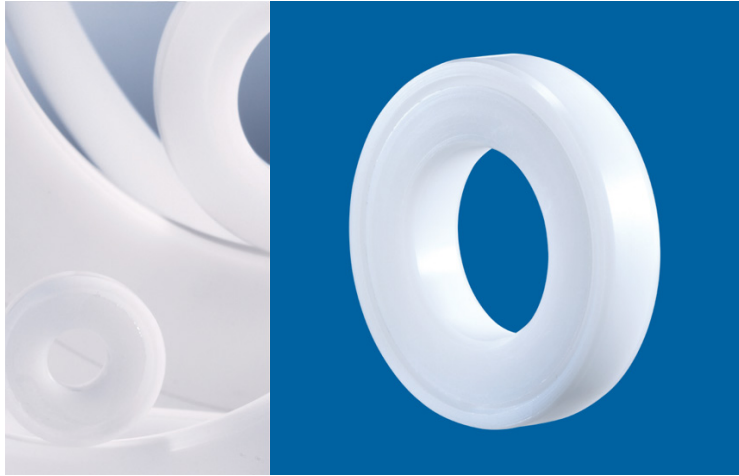

S 36 X 62 X 10

Item number 301555

Technical data

Material:	High-quality polyoxymethylene (POM)
Inner diameter ID:	36 mm
Outer diameter OD:	62 mm
Installed width W:	10 mm
Sealing gap:	Conical
Axial play S_{ax}^* :	0.8 mm
Gap diameter e_1 :	46 mm
Gap diameter e_2 :	56 mm
Speed limit:	23500 rpm
Weight:	0.0222 kg
Operating temperature t:	-40° - 60°C

*Entire movability from one end position to the other

Installation

"l" Length (chamfering of shaft and housing) depending on the width W: $l = 0,1 \times W$

Component tolerances

Surrounding structure (mating parts)

Housing: H7 / Shaft: h7

Surface quality: $R_z \leq 16 \mu\text{m}$; $R_a \leq 3,2 \mu\text{m}$

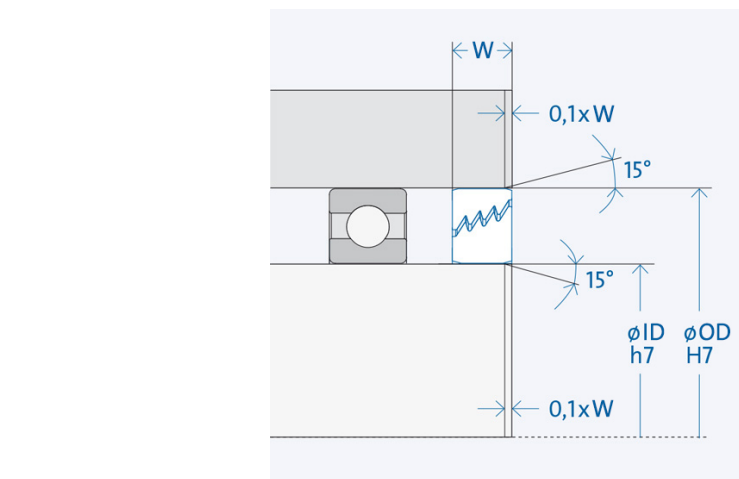
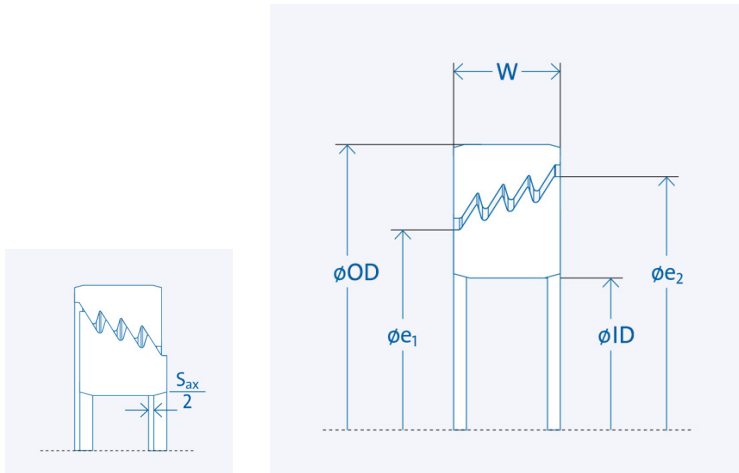

The larger gap diameter e_2 must always face the impact.