

# Spindle ball bearing HY S 6012 E TA P4+

16.07.2024



## Components

Bearing designation:	HY S 6012 E TA
Bearing design:	S
Series / size:	6012
Ball material:	Ceramic
Cage:	TA
Seal:	2RZ upon request
Precision:	P4+ (UP+ Upon request)
Main dimensions [d x D x B]:	60 x 95 x 18 mm

## Load data

Static load capacity	$C_{0r}$ : 30000 N
Dynamic load capacity	$C_r$ : 32000 N
Fatigue load limit	$C_U$ : 1127 N
Speed limit	$n_{grease}$ : 17625 1/min
Speed limit	$n_{oil}$ : 23500 1/min
Light preload	L: 270 N
Axial rigidity	$C_{ax}$ : 199 N/ $\mu$ m
Medium preload	M: 810 N
Axial rigidity	$C_{ax}$ : 301 N/ $\mu$ m
Heavy preload	S: 1620 N
Axial rigidity	$C_{ax}$ : 399 N/ $\mu$ m
Spring preload	Ff: 2140 N (for $n_{max}$ )

## Geometrical Data

Bore diameter	d: 60 mm	Oiling nozzle position	$d_7$ : 74.9 mm
Outer diameter	D: 95 mm	Pitch circle diameter	$d_m$ : 77.5 mm
Width of single bearing	B: 18 mm	Inner diameter of outer ring	$D_1$ : 83.2 mm
Ball diameter	$D_w$ : 9.525 mm	Undercut of associated component	$r_{a \max}$ : 1 mm
Number of balls	Z: 22	Undercut of associated component (open side)	$r_{b \max}$ : 1 mm
Chamfer (min)	$r_{1,2 \min}$ : 1.1 mm	Abutment diameter inner ring	$d_{a,b \min}$ : 66.4 mm
Chamfer (min), open side	$r_{3,4 \min}$ : 1 mm	Abutment diameter outer ring	$D_{a,b \max}$ : 89.5 mm
Outer diameter of inner ring	$d_1$ : 71.9 mm	Inner diameter of outer ring (open side)	$D_2$ : 87.1 mm
Outer diameter of inner ring (open side)	$d_2$ : -	Bearing weight	m: 0.37 kg
		Contact angle	Alpha 0: 25°

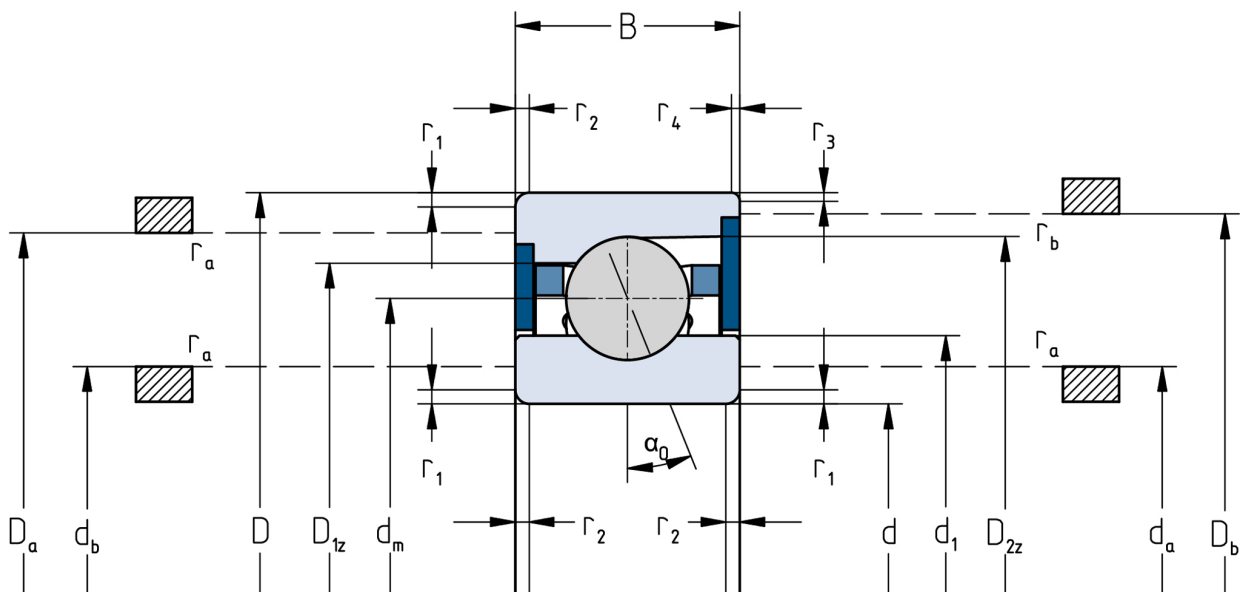

The given speed limits apply to individual bearings with spring preload. Correction factors must be considered for all properties which deviate from this.