

HV-X 150 - 30000/37

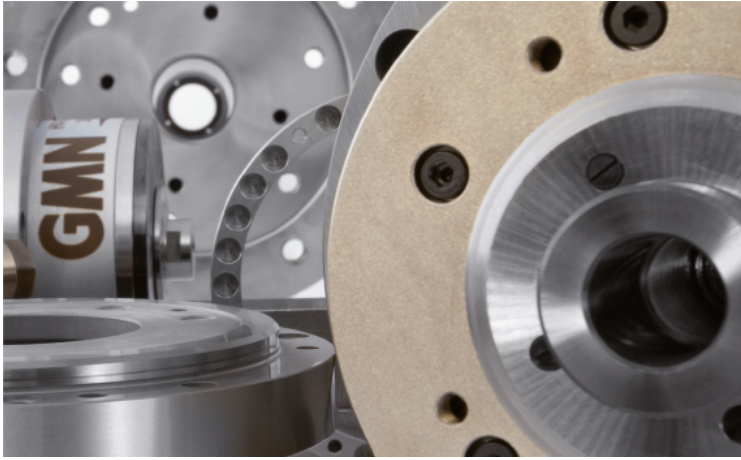

Technical data

| | | |
|---------------------------------|---------------|----------------------|
| ∅ Spindle housing | A | [mm] |
| Speed max. | n_{max} | [min ⁻¹] |
| Bearing; front | W_1 | [mm] |
| Tool interface | | |
| ∅ Flat layout | W | [mm] |
| Static rigidity | | |
| axial | C_{ax} | [N/μm] |
| radial | C_{rad} | [N/μm] |
| Motor realization | | |
| Frequency max. | f_{max} | [Hz] |
| Converter voltage ¹⁾ | | [V] |
| Power | P_{S1} | [kW] |
| Torque | M_{S1} | [Nm] |
| ... at speed | n | [min ⁻¹] |
| Current | I_{S1} | [A] |
| Power | $P_{S6-60\%}$ | [kW] |
| Torque | $M_{S6-60\%}$ | [Nm] |
| ... at speed | n | [min ⁻¹] |
| Current | $I_{S6-60\%}$ | [A] |

HV-X 150 - 30000/37

| | | |
|---------|-------|-------|
| 150 | | |
| 30000 | | |
| 65 | | |
| D 36/63 | | |
| 63 | | |
| 121 | | |
| 197 | | |
| 200 V | 350 V | 460 V |
| 1000 | | |
| 200 | 350 | 460 |
| 33 | | |
| 15 | | |
| 21000 | | |
| 147 | 84 | 64 |
| 37 | | |
| 16,8 | | |
| 21000 | | |
| 161 | 92 | 70 |

TECHNICAL DATA

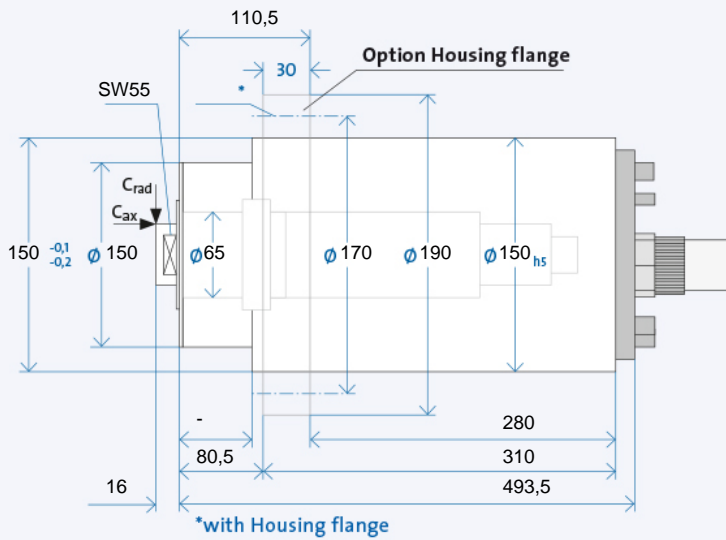

Electrical connection

| | | | |
|--------------------------|------|-----|-----|
| Plug type | D350 | MAC | MAC |
| Straight plug connection | + | + | + |
| Coil plug connector | o | o | o |
| Fixed cable XXm | o | o | o |

Coolant feed through the shaft

| | |
|--------------------|---|
| Low pressure (du) | x |
| High-pressure (dh) | o |

Sensors

| | |
|----------------|---|
| Rotary encoder | o |
| Speed sensor | + |

Housing

| | |
|---------------------------------|---|
| Cylindrical housing | + |
| Cylindrical housing with flange | o |
| Block housing | x |
| Air-tight seal | o |

¹⁾ Minimum required starting voltage for the frequency converter.

- + Standard
- o Optional
- x Upon request

Ordering information:

HV-X 150 - 30000/37
 R is for clockwise, L for counter-clockwise
 + Desired options

| | | |
|------|-----|-----|
| D350 | MAC | MAC |
| + | + | + |
| o | o | o |
| o | o | o |
| | x | |
| | o | |
| | + | |
| | + | |
| | o | |
| | x | |
| | o | |

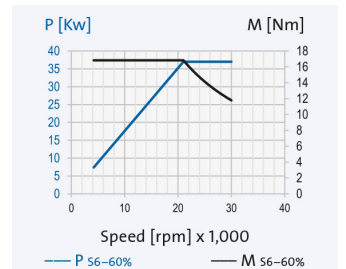

FIT HOLES WITH FLAT LAYOUT

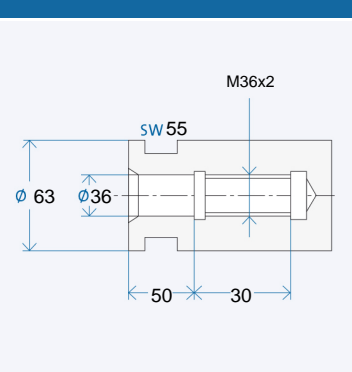

ANGLED PLUG OPTION

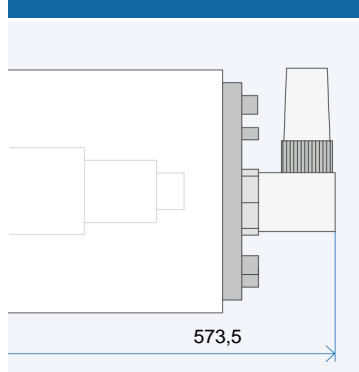

The data currently provided on the internet apply. Further and detailed information is provided in the GMN 2508 catalogue.

HV-X 150 - 30000/37

Grinding quills

GMN produces grinding quills with high round and flat face accuracy for all available GMN grinding mandrel receivers.

FIG. 1: CEMENTED (KI)

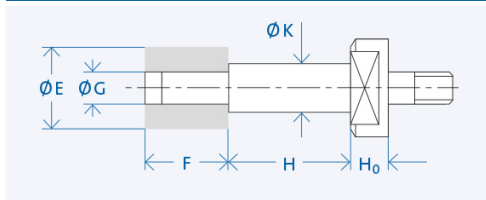

FIG. 2: WITH ADJUSTMENT SCREW (PS)

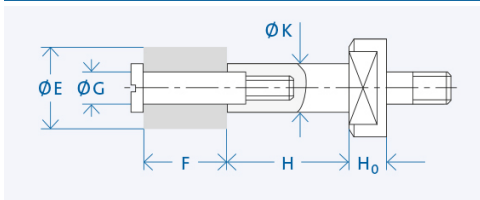
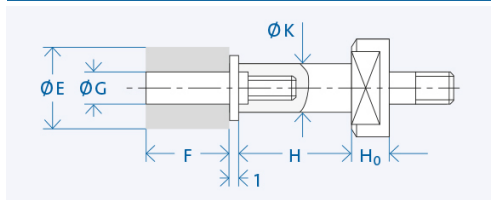
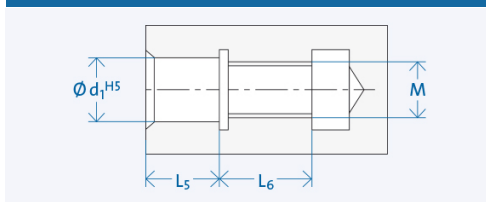

FIG. 3: FOR GRINDING WHEELS ON THREADED PIN (PL)*



FITTING HOLE FOR FIG. 2 AND 3



| d ₁ | M | L ₅ | L ₆ |
|----------------|-----|----------------|----------------|
| 4 | M3 | 5 | 8 |
| 6 | M5 | 7 | 11 |
| 8 | M6 | 9 | 12 |
| 10 | M8 | 12 | 14 |
| 13 | M12 | 13 | 17 |

| Interface | K [mm] | H [mm] | Wheel E x F [mm] | G [mm] | Grinding wheel attachment | H ₀ [mm] |
|-----------|--------|--------|------------------|--------|---------------------------|---------------------|
| D 36/63 | 25 | 50 | 40 x 32 | 16 | MU | 15 |
| | 32 | 63 | 50 x 40 | 20 | MU | |
| | 50 | 100 | 80 x 40 | 32 | MU | |

Ordering information:

[Mandrel Ø K] x [Mandrel length H] - [Grinding wheels ø G] x [Grinding wheel width F] [Interface] [Mandrel fixation]

Example: Grinding quill 16 x 40 - 10 x 25 D16/28 PS

Semi-finished goods

GMN semi-finished products allow the individual adaptation of the tool interface for any connections.

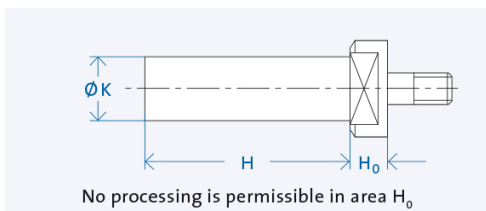

| d ₁ | K [mm] | H [mm] |
|----------------|--------|--------|
| D 36/63 | 63 | 150 |

Ordering information: »Semi-finished goods« [Shaft Ø K] x [Shaft length H] [Interface]

Example: Semi-finished goods 34 x 180 D16/33

Lubrication system



The electronically controlled PRELUB lubrication unit is optimally adapted to the oil-air lubricated GMN spindles and guarantees a long service life.

Cooling system



GMN cooling units ensure precisely adjustable temperature and quantity delivery of the coolant and achieve consistently low operating temperatures.

Cable and plug



Ready-made cables with B048, B049, GA, MAC, D500 and STK plugs are available on request. For the spindle/converter connection, GMN supplies UL/CSA approved electrical cables suitable for use in drag chains.